

INSTALLATION

STEP 1

QUIK NICHE INSTALLATION TO FRAMING

Install framing / nogs to suit niche size and provide fixing for wallboard. Adhere niche to framing by applying 'daubs' of supplied silicone to back-side of niche perimeter flanges. Niche is to finish flush with wallboard front surface. (6mm gap between niche and framing).

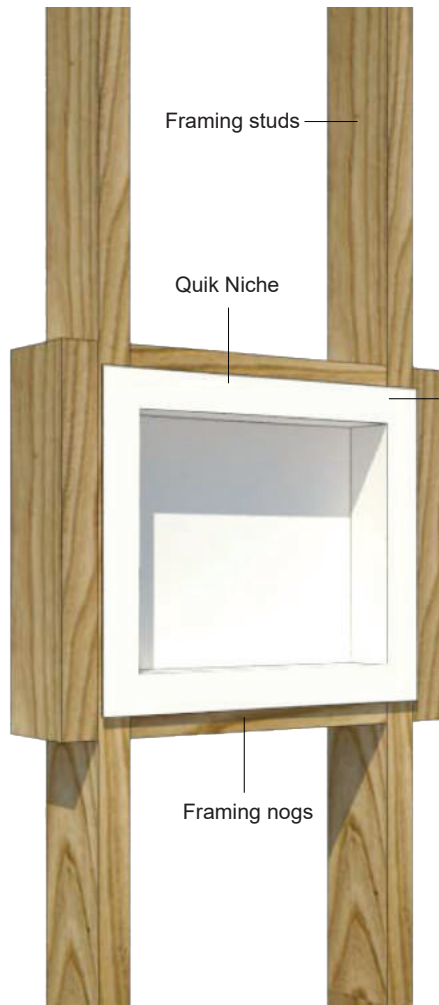

Membrane
NOTE:
Ensure membrane is applied tightly against surface and corner welds.

STEP 2

WALLBOARD AFFIXED TO FRAMING

Cut hole in plasterboard or fibre-cement wallboard slightly larger than niche and affix wallboard to framing. Apply supplied 'peel and stick' membrane pieces to all niche surfaces and perimeter flanges.

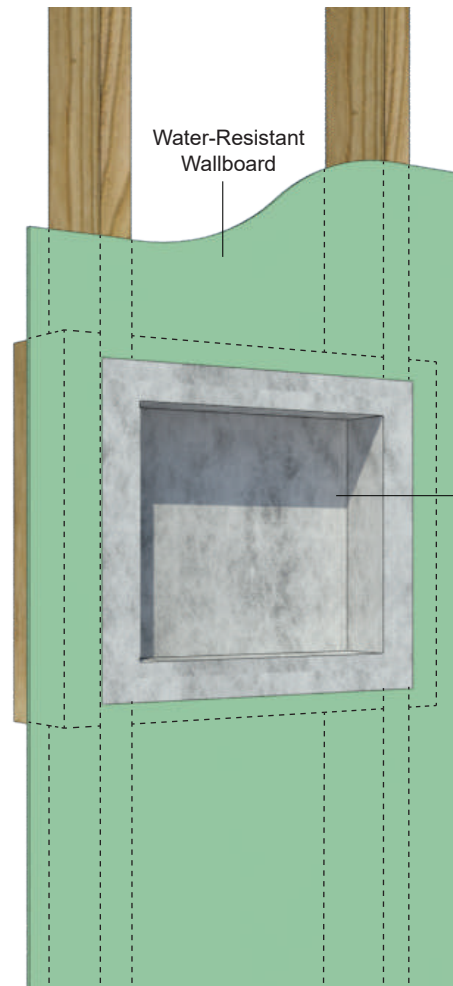

STEP 3

LIQUID-APPLIED WATERPROOFING APPLICATION

Waterproofer / tiler is to apply a 'bandage' connection tape to wallboard / niche perimeter joint. Liquid waterproofing to be applied to wallboard and entire niche.

